

STONE



Earlswood Road RH1

Guide price: £425,000 to £450,000

“At Stone, we’re passionate about the unique and awe-inspiring architectural elements that transform houses into dream homes.”

————— *The Stone Family*



Along one of Earlswood's characterful residential streets, this attractive red brick period cottage is a home that feels instantly welcoming. Its traditional façade, paired with the convenience of a private driveway, hints at the thoughtful balance of character and practicality that continues throughout. It is the sort of home that has evolved gently over time, carefully modernised while preserving the features that give period cottages their enduring appeal.

Inside, the living room immediately sets the tone. Warm oak flooring runs beneath your feet, while a beautifully painted mantel frames the original cast iron fireplace. Bespoke shelving on either side creates an elegant focal point, and a compact log burner transforms the room into a wonderfully cosy retreat during the colder months. It is an inviting space that feels equally suited to quiet evenings by the fire as it does to gathering with friends.

Beyond, the dining room and kitchen have been connected through two graceful arches, allowing each room to retain its own identity whilst flowing naturally together. The dining room centres around a second handsome fireplace with a traditional open fire, creating a setting that feels both intimate and timeless. The adjoining kitchen introduces a brighter, contemporary feel, with crisp white cabinetry complemented by warm oak worktops, chrome detailing and integrated appliances. A butler sink overlooks the breakfast bar, making everyday moments, from morning coffee to preparing supper, feel effortlessly enjoyable.



Double doors invite you outside to a raised deck, where summer naturally spills outdoors. There is ample space for barbecues, relaxed dining and long evenings with family and friends, while the lawn beyond provides a lovely setting for children to play or simply to enjoy a peaceful afternoon in the sunshine. It is a garden that feels wonderfully manageable, yet generous enough to become a true extension of the home throughout the warmer months. A downstairs cloakroom completes the ground floor.

Upstairs, two generous double bedrooms continue the cottage's charm. The principal bedroom enjoys an abundance of natural light and retains its own character fireplace, creating a calm and restful retreat. The second bedroom is equally bright and spacious, enhanced by an attractive pocket door that makes thoughtful use of the space. Completing the first floor, the family bathroom has been finished in timeless monochrome tones, combining marble-effect tiling with both a separate bath and shower to offer comfort for busy mornings as well as slower evenings.







Life in Earlswood is defined by its sense of community and its balance between town and countryside. Earlswood Station is within walking distance, providing straightforward connections into London, while Redhill town centre is also easily reached on foot, offering supermarkets, cafés, restaurants, leisure facilities and everyday amenities close at hand. It is a location that makes commuting and daily life feel refreshingly uncomplicated.

For those who enjoy spending time outdoors, Earlswood Common and Redhill Common are both nearby, offering miles of woodland paths, open heathland and tranquil ponds that have long made this area popular with walkers, runners and dog owners alike. A short drive also brings you to Priory Farm, where the much-loved Discovery Walk, farm shop, garden centre and café make it a favourite destination throughout the seasons.

Families are particularly well served, with highly regarded schools including Earlswood Infant & Nursery School, Earlswood Junior School and St Bede's School all within easy reach. Beyond Earlswood, nearby Reigate adds another layer to the area's appeal, with its historic High Street lined with independent boutiques, welcoming pubs, excellent restaurants and a lively calendar of community events that continue to make this corner of Surrey such a sought-after place to call home.







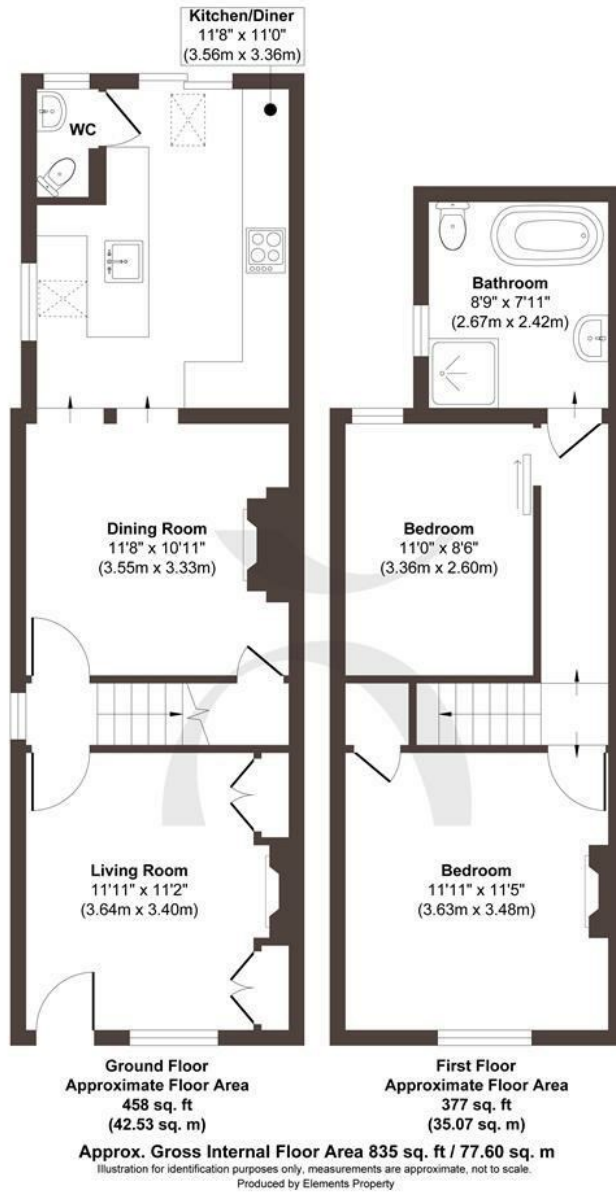

STONE

The Details

- Guide price: £425,000 to £450,000
- Charming semi-detached period cottage in the heart of Earlswood
- Attractive red brick façade with a private driveway
- Beautiful living room with cast iron fireplace, bespoke shelving and log burner
- Separate dining room with traditional open fireplace
- Bright contemporary kitchen with oak worktops, butler sink and integrated appliances
- Private rear garden with lawn for leisure and play
- Decking terrace ideal for outdoor dining and entertaining
- Two generous double bedrooms, including a principal bedroom with original fireplace
- Exceptional location for commuting, schools and lifestyle

Energy Performance Certificate (EPC)
Band D

Council Tax Band
D



STONE

Let's Talk

01737 301 557

hello@stoneestateagents.co.uk

stoneestateagents.co.uk

The particulars above are a guide, not an offer or contract. Descriptions photographs and plans are not statements or representations of fact. Measurements are approximate and not to scale. Prospective purchasers must verify the accuracy of the information within the particulars. Stone does not give any representations or warranties; nor represent the Seller legally. Stone has no liability, for any costs, losses or expenses incurred by the Seller or a prospective buyer relating to the sales and buying transaction. Our Sales Disclaimer, trading names and privacy policy on how your data is processed and used is found in full on our website in our Privacy Statement.

© Stone Estate Agents 2023 All rights Reserved